

# Sets with PALL® filters are coming!

In an effort to optimize our supply chain, prevent supply shortage and maintain Eitan Medical's sets quality, Eitan Medical announces the replacement of the GVS filter supplier with filter parts from PALL®. PALL® is a validated supplier, complying with regulatory standards: the air-elimination filter has the same indication and patient protection.

You'll start to receive administration sets with filters that appear different from the GVS filters, however, please be assured that the difference is only in the appearance, the indication is the same.

\*You may still receive sets with GVS filters till the transition period is completed.

This information does not replace the official instruction for use.  
For further information please contact your local service provider or Eitan Medical.

By using this training material, you agree to the training materials terms of use as describes on our web site [www.eitanmedical.com/term\\_training\\_materials](http://www.eitanmedical.com/term_training_materials)

TRG-0009486, Rev.05 | August 2023

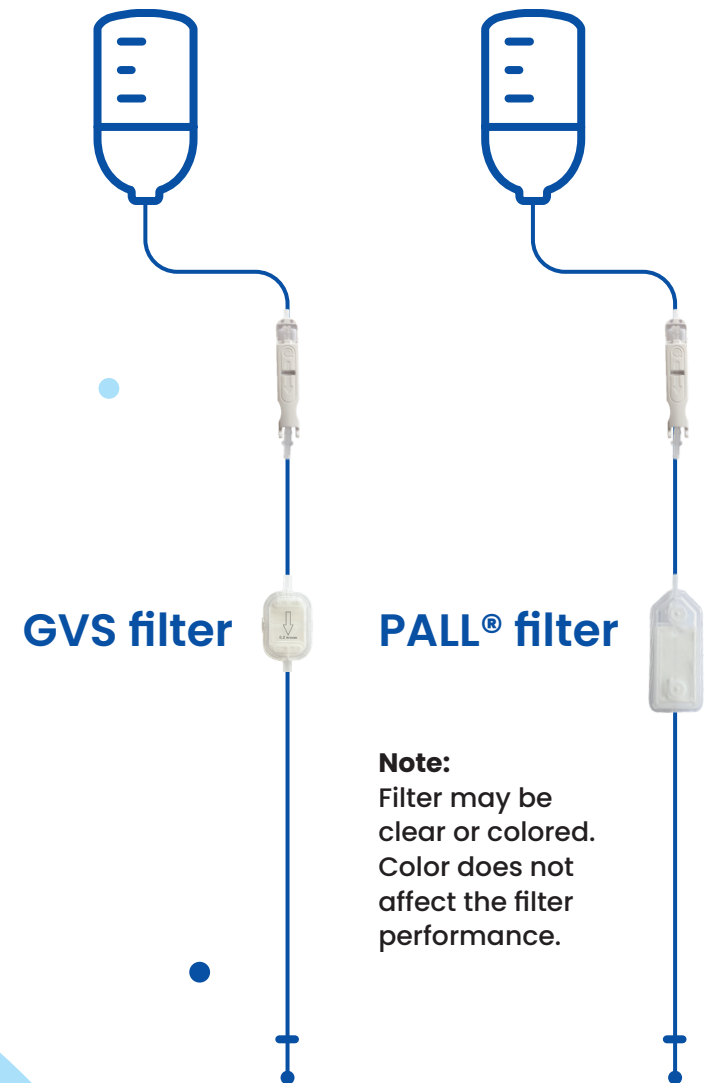

# Priming

Priming is the process used to fill the administration set with medication, removing all air from the set. It is recommended to prime the administration set using the pump. When instructed to prime the administration set, follow these steps:

1. Verify the administration set is disconnected from the catheter/access site:

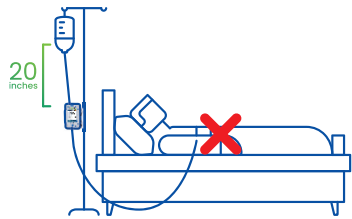

2. Open all clamps on the administration set and make sure there are no other occlusions blocking the set:

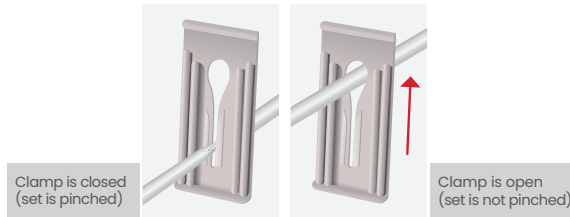

3. Hold the filter in an upright (vertical) position:

Hold the GVS filter so the arrow on the filter is pointing up toward the ceiling

**INVERT FILTER**

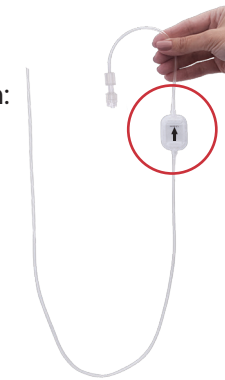

Hold the PALL® filter so the arrow side of the filter is pointing up toward the ceiling:

**DO NOT INVERT FILTER**

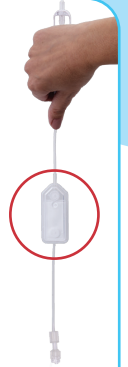

4. Allow the medication to prime the filter, wetting the filter membrane and eliminating air. Once all air has been removed and fluid is observed at the end of the set, priming is complete.

5. If you are not connecting the patient to the administration set once priming is complete, clamp below the filter until the patient is connected.

# During Infusion

During an infusion, keep filter below catheter/access site:

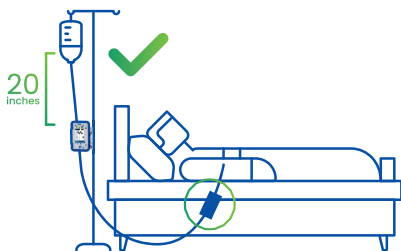

## FAQs

1. **What size filters are available?**  
1.2 and 0.2 micron. All filters are air eliminating.
2. **Are filters low protein binding?**  
Yes. Hydrophilic membrane material is polyethersulfone (PES), which is considered low protein binding.
3. **How should a primed set be transported to prevent leakage and maintain filter prime?**  
Ensure administration set's end cap is secure. Close clamp below filter.



[www.eitanmedical.com](http://www.eitanmedical.com)